

3HS SERIES, THREE ELEMENT STAINLESS STEEL HEATERS					
WATTS	VOLTS	HOT ZONE In./(mm)	OVERALL LENGTH In./(mm)	MODEL NUMBER	SHIP WGT. Lbs./(kg)
3000	240	10	17	3HS3217-**-	9
	480	(255)	(430)	3HS3417-**-	(4)
4500	240	16	23	3HS4.5223-**-	10
	480	(405)	(585)	3HS4.5423-**-	(4.5)
7500	240	20	29	3HS7.5229-**-	12
	480	(510)	(735)	3HS7.5429-**-	(5.5)
10500	240	25	34	3HS10.5234-**-	14
	480	(635)	(865)	3HS10.5434-**-	(6.5)

Three phase standard, single phase available as option. Add "-1" before thermal protector designator.

Product Features and Benefits:

- ◆ **SUPERIOR CHEMICAL RESISTANCE:** For use in most aqueous alkaline solutions and rinse tanks. Check solution recommendation chart or with your chemical supplier for proper sheath material selection.
- ◆ **RUGGED CONSTRUCTION:** Heavy wall metal sheaths in 316 stainless steel.
- ◆ **OUTSTANDING PERFORMANCE:** Watt densities of 40 watts per square inch (6.2 w/cm²) use minimal space and ensure long service life.
- ◆ **CORROSION RESISTANT HEAD:** Vapor tight, flame retardant polypropylene terminal enclosure with 3-foot (.9m) flexible PVC liquid tight conduit.
- ◆ **SAFETY FEATURES:**
 - Grounded construction.
 - Thermal protector built in. Replaceable PI fuse standard for solutions up to 180°F (82°C).
 - Non-floating construction.
- ◆ **CERTIFICATIONS:** UL, CSA and CE.
- ◆ **SIZES:** 3,000 watts to 10,500 watts.
- ◆ **VOLTAGES:** 240 or 480 volts. 208, 380, 415, 600 and other voltages available. Three phase standard, single phase available.
- ◆ **OPTIONS AVAILABLE** (consult factory):
 - Replaceable thermal protectors:
 - PIM: for solutions from 180°F (82°C) to 230°F (110°C).
 - PIH: for solutions from 230°F (110°C) to 300°F (150°C).
 - Resettable thermal protectors:
 - PII: for solutions up to 180°F (82°C).
 - PIIM: for solutions from 180°F (82°C) to 230°F (110°C).
 - PIIH: for solutions from 230°F (110°C) to 300°F (150°C).
 - Special configurations and lengths.
 - Longer wire and conduit lengths.
 - Lower watt densities for highly viscous solutions.
 - Titanium elements.
 - Temperature and level controls sized to match the heater.

DIMENSIONS

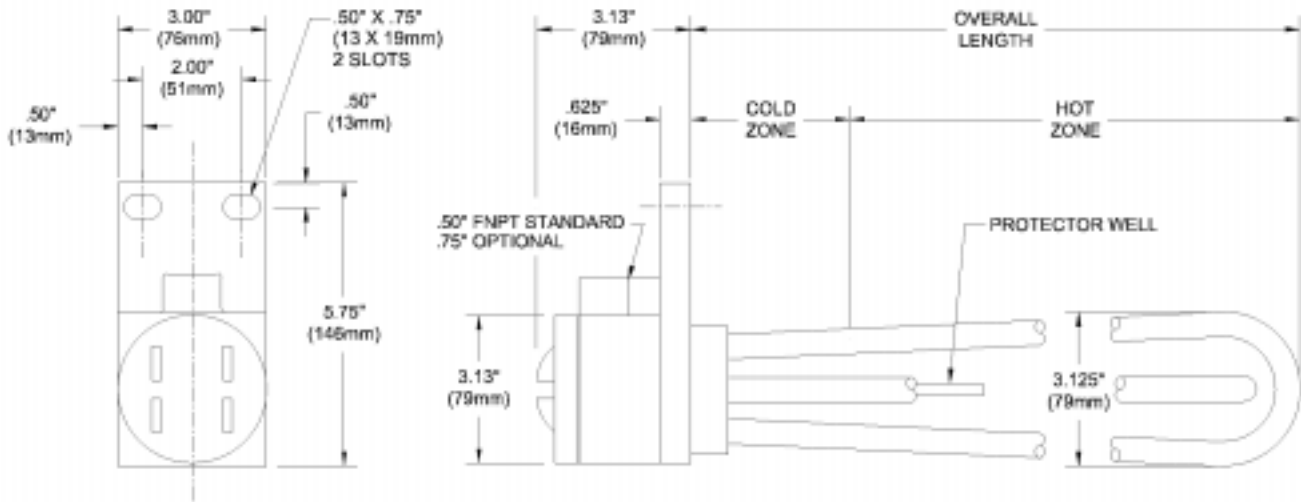

3 ELEMENT OVER THE SIDE HEATER

Series	Wattage	Voltage	Overall Length	Options	Type of Fuse	Wire and Conduit Length
	3 = 3000 4.5 = 4500 7.5 = 7500 10.5 = 10500	2 = 240 4 = 480 -208- = 208 -380- = 380 -415- = 415 -600- = 600	17 = 3kW 23 = 4.5kW 29 = 7.5kW 34 = 10.5kW			36" length standard (no designator) specify variations from standard Ex: -X84 = 84"
	3HS = 3 element, 316 stainless steel					
	X = any special configuration not called out in the part number (specify in clear text) no designator = three phase power (standard) -1 = single phase power					
					Replaceable Fuse	
					-PI (std) for solutions up to 180°F -PIM for 180° - 230°F solutions -PIH for 230° - 300°F solutions	
					Resettable Fuse (additional control components required)	
					-PII for solutions up to 180°F -PIIM for 180° - 230°F solutions -PIIH for 230° - 300°F solutions	

ORDERING EXAMPLE:

3HS3417-PII

3 element, 316 stainless steel, 3000 watt, 480 volt, 17" overall length, PII fuse.

**PROCESS
TECHNOLOGY**

Star Electric to Order Call 1.800.345.0369

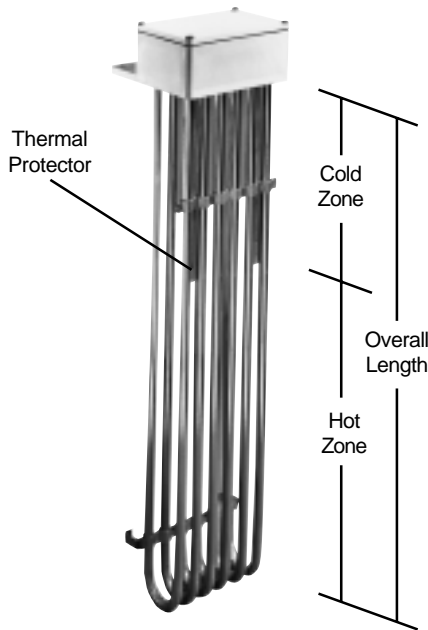

6HS SERIES, SIX ELEMENT STAINLESS STEEL HEATERS					
WATTS	VOLTS	HOT ZONE In./(mm)	OVERALL LENGTH In./(mm)	MODEL NUMBER	SHIP WGT. Lbs./(kg)
6000	240	10	17	6HS6217-**	12
	480	(255)	(430)	6HS6417-**	(5.5)
9000	240	16	23	6HS9223-**	13
	480	(405)	(585)	6HS9423-**	(6)
15000	240	20	29	6HS15229-**	16
	480	(510)	(735)	6HS15429-**	(7.5)
21000	240	25	34	6HS21234-**	18
	480	(635)	(865)	6HS21434-**	(8.5)

Three phase standard, single phase available as option. Add "-1" before thermal protector designator.

Product Features and Benefits:

- ◆ **SUPERIOR CHEMICAL RESISTANCE:** For use in most aqueous alkaline solutions and rinse tanks. Check solution recommendation chart or with your chemical supplier for proper sheath material selection.
- ◆ **RUGGED CONSTRUCTION:** Heavy wall metal sheaths in 316 stainless steel.
- ◆ **OUTSTANDING PERFORMANCE:** Watt densities of 40 watts per square inch (6.2 w/cm²) use minimal space and ensure long service life.
- ◆ **CORROSION RESISTANT HEAD:** Vapor tight, flame retardant polypropylene terminal enclosure with 3-foot (.9m) flexible PVC liquid tight conduit.
- ◆ **SAFETY FEATURES:**
 - Grounded construction.
 - Thermal protector built in. Replaceable PI fuse standard for solutions up to 180°F (82°C).
 - Non-floating construction.
- ◆ **CERTIFICATIONS:** UL, CSA and CE.
- ◆ **SIZES:** 6,000 watts to 21,000 watts.
- ◆ **VOLTAGES:** 240 or 480 volts. 208, 380, 415, 600 and other voltages available. Three phase standard, single phase available.
- ◆ **OPTIONS AVAILABLE** (consult factory):
 - Replaceable thermal protectors:
 - PIM: for solutions from 180°F (82°C) to 230°F (110°C).
 - PIH: for solutions from 230°F (110°C) to 300°F (150°C).
 - Resettable thermal protectors:
 - PII: for solutions up to 180°F (82°C).
 - PIIM: for solutions from 180°F (82°C) to 230°F (110°C).
 - PIIH: for solutions from 230°F (110°C) to 300°F (150°C).
 - L-Shaped and other special configurations and lengths.
 - Longer wire and conduit lengths.
 - Lower watt densities for highly viscous solutions.
 - Titanium elements.
 - Temperature and level controls sized to match the heater.

DIMENSIONS

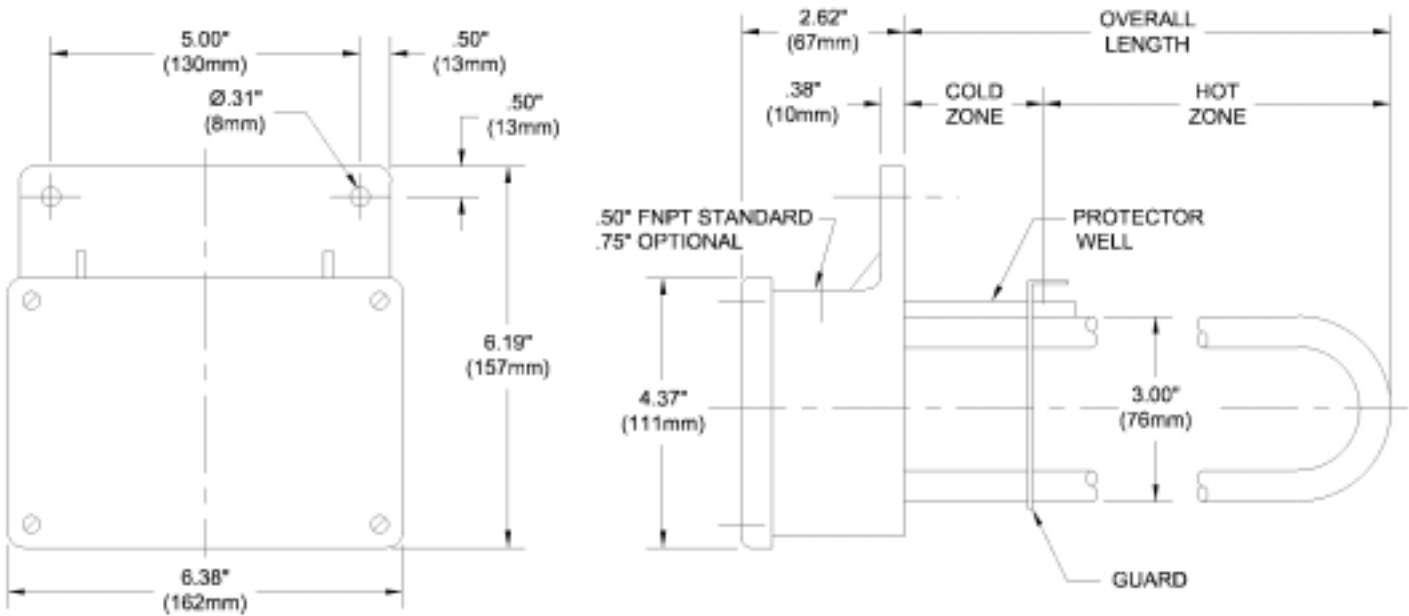

6 ELEMENT OVER THE SIDE HEATER

Series	Wattage	Voltage	Overall Length	Options	Type of Fuse	Wire and Conduit Length
	6 = 6000 9 = 9000 15 = 15000 21 = 21000	2 = 240 4 = 480 -208 = 208 -380 = 380 -415 = 415 -600 = 600	17 = 6kW 23 = 9kW 29 = 15kW 34 = 21kW			36" length standard (no designator) specify variations from standard Ex: -X84 = 84"
	6HS = 6 element, 316 stainless steel					
X = any special configuration not called out in the part number (specify in clear text) no designator = three phase power (standard) -1 = single phase power						
					Replaceable Fuse	
					-PI (std)	for solutions up to 180°F
					-PIM	for 180° - 230°F solutions
					-PIH	for 230° - 300°F solutions
					Resettable Fuse (additional control components required)	
					-PII	for solutions up to 180°F
					-PIIM	for 180° - 230°F solutions
					-PIIH	for 230° - 300°F solutions

ORDERING EXAMPLE:

6HS6217-1-PI

6 element, 316 stainless steel, 6000 watt, 240 volt, 17" overall length, single phase, PI fuse.



Star Electric to Order Call 1.800.345.0369

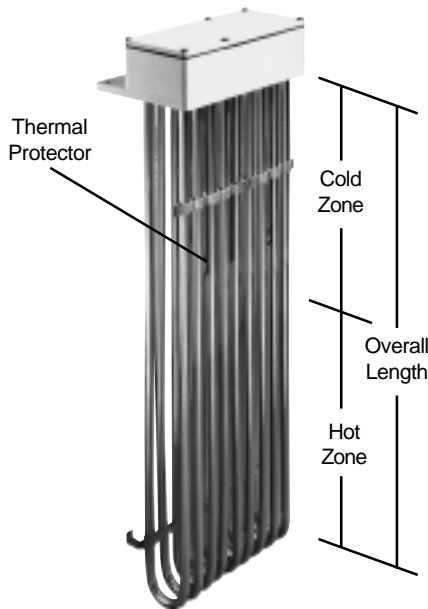

9HS SERIES, NINE ELEMENT STAINLESS STEEL HEATERS					
WATTS	VOLTS	HOT ZONE	OVERALL LENGTH	MODEL NUMBER	SHIP WGT. Lbs./kg
		In./mm	In./mm		
9000	240	10	17	9HS9217-**	16
	480	(255)	(430)	9HS9417-**	(7.5)
13500	240	16	23	9HS13.5223-**	19
	480	(405)	(585)	9HS13.5423-**	(9)
22500	240	20	29	9HS22.5229-**	23
	480	(510)	(735)	9HS22.5429-**	(10.5)
31500	240	25	34	9HS31.5234-**	25
	480	(635)	(835)	9HS31.5434-**	(11.5)

Three phase standard, single phase available as option. Add "-1" before thermal protector designator.

Product Features and Benefits:

- ◆ **SUPERIOR CHEMICAL RESISTANCE:** For use in most aqueous alkaline solutions and rinse tanks. Check solution recommendation chart or with your chemical supplier for proper sheath material selection.
- ◆ **RUGGED CONSTRUCTION:** Heavy wall metal sheaths in 316 stainless steel.
- ◆ **OUTSTANDING PERFORMANCE:** Watt densities of 40 watts per square inch (6.2 w/cm²) use minimal space and ensure long service life.
- ◆ **CORROSION RESISTANT HEAD:** Vapor tight, flame retardant polypropylene terminal enclosure with 3-foot (.9m) flexible PVC liquid tight conduit.
- ◆ **SAFETY FEATURES:**
 - Grounded construction.
 - Thermal protector built in. Replaceable PI fuse standard for solutions up to 180°F (82°C).
 - Non-floating construction.
- ◆ **CERTIFICATIONS:** UL, CSA and CE.
- ◆ **SIZES:** 9,000 watts to 31,500 watts.
- ◆ **VOLTAGES:** 240 or 480 volts. 208, 380, 415, 600 and other voltages available. Three phase standard, single phase available.
- ◆ **OPTIONS AVAILABLE** (consult factory):
 - Replaceable thermal protectors:
 - PIM: for solutions from 180°F (82°C) to 230°F (110°C).
 - PIH: for solutions from 230°F (110°C) to 300°F (150°C).
 - Resettable thermal protectors:
 - PII: for solutions up to 180°F (82°C).
 - PIIM: for solutions from 180°F (82°C) to 230°F (110°C).
 - PIIH: for solutions from 230°F (110°C) to 300°F (150°C).
 - L-Shaped and other special configurations and lengths.
 - Longer wire and conduit lengths.
 - Lower watt densities for highly viscous solutions.
 - Titanium elements.
 - Temperature and level controls sized to match the heater.

DIMENSIONS

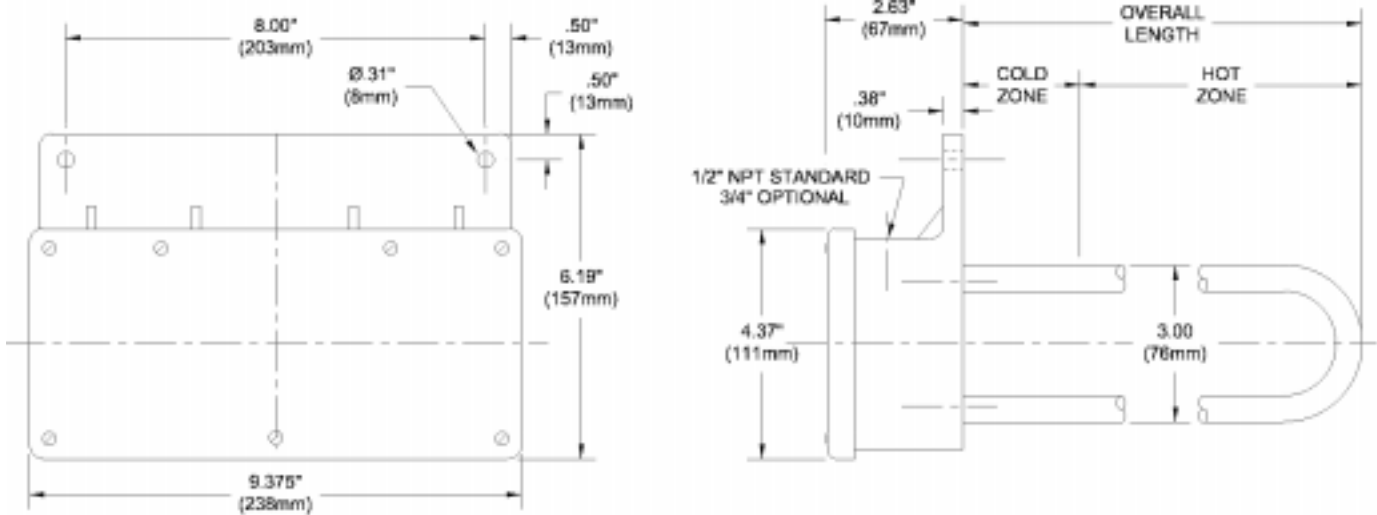

9 ELEMENT OVER THE SIDE HEATER

Series	Wattage	Voltage	Overall Length	Options	Type of Fuse	Wire and Conduit Length
	9 = 9000 13.5 = 13500 22.5 = 22500 31.5 = 31500	2 = 240 4 = 480 -208- = 208 -380- = 380 -415- = 415 -600- = 600	17 = 9kW 23 = 13.5kW 29 = 22.5kW 34 = 31.5kW			36" length standard (no designator) specify variations from standard Ex: -X84 = 84"
	9HS = 9 element, 316 stainless steel					
	X = any special configuration not called out in the part number (specify in clear text) no designator = three phase power (standard) -1 = single phase power					
					Replaceable Fuse	
					-PI (std) for solutions up to 180°F -PIM for 180° - 230°F solutions -PIH for 230° - 300°F solutions	
					Resettable Fuse (additional control components required)	
					-PII for solutions up to 180°F -PIIM for 180° - 230°F solutions -PIIH for 230° - 300°F solutions	

ORDERING EXAMPLE:

9HS9-208-17-PIM-X96

9 element, 316 stainless steel, 9000 watt, 208 volt, 17" overall length, PIM fuse, 96" conduit and leads.

**PROCESS
TECHNOLOGY**

Star Electric to Order Call 1.800.345.0369